

1. etasje - EL-Tavle og BKK-Trafo
1:50

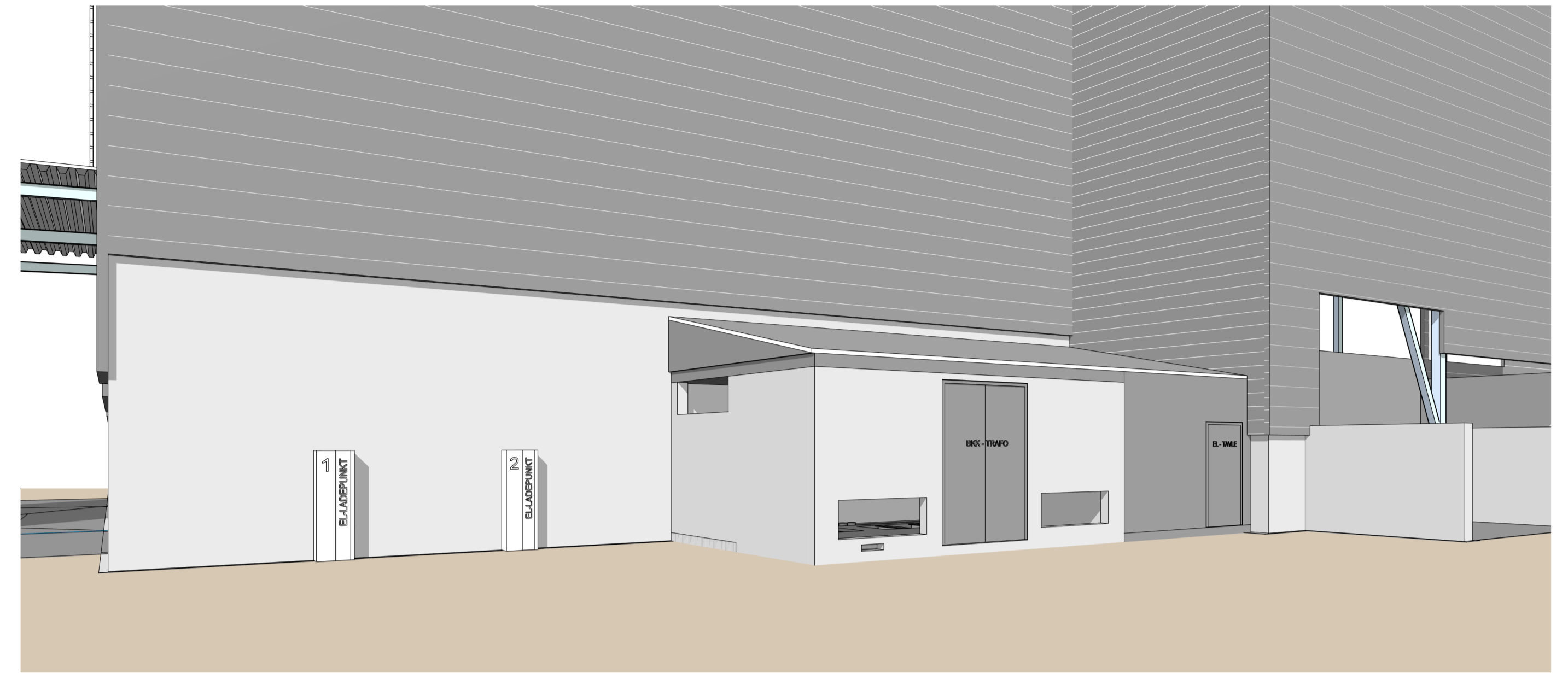

2 BKK-Trafo og EL-Tavle

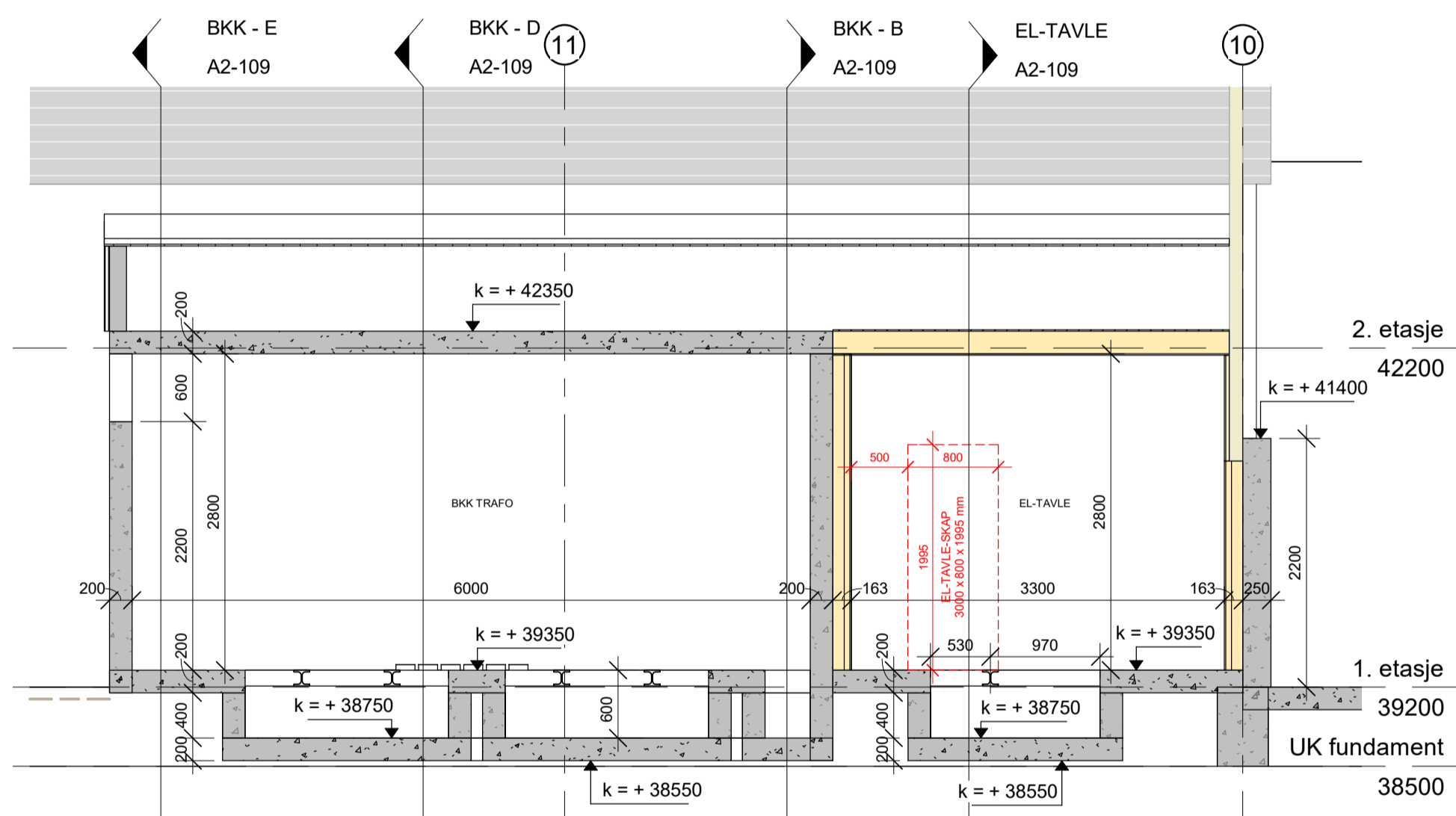

3 BKK - A
1:50

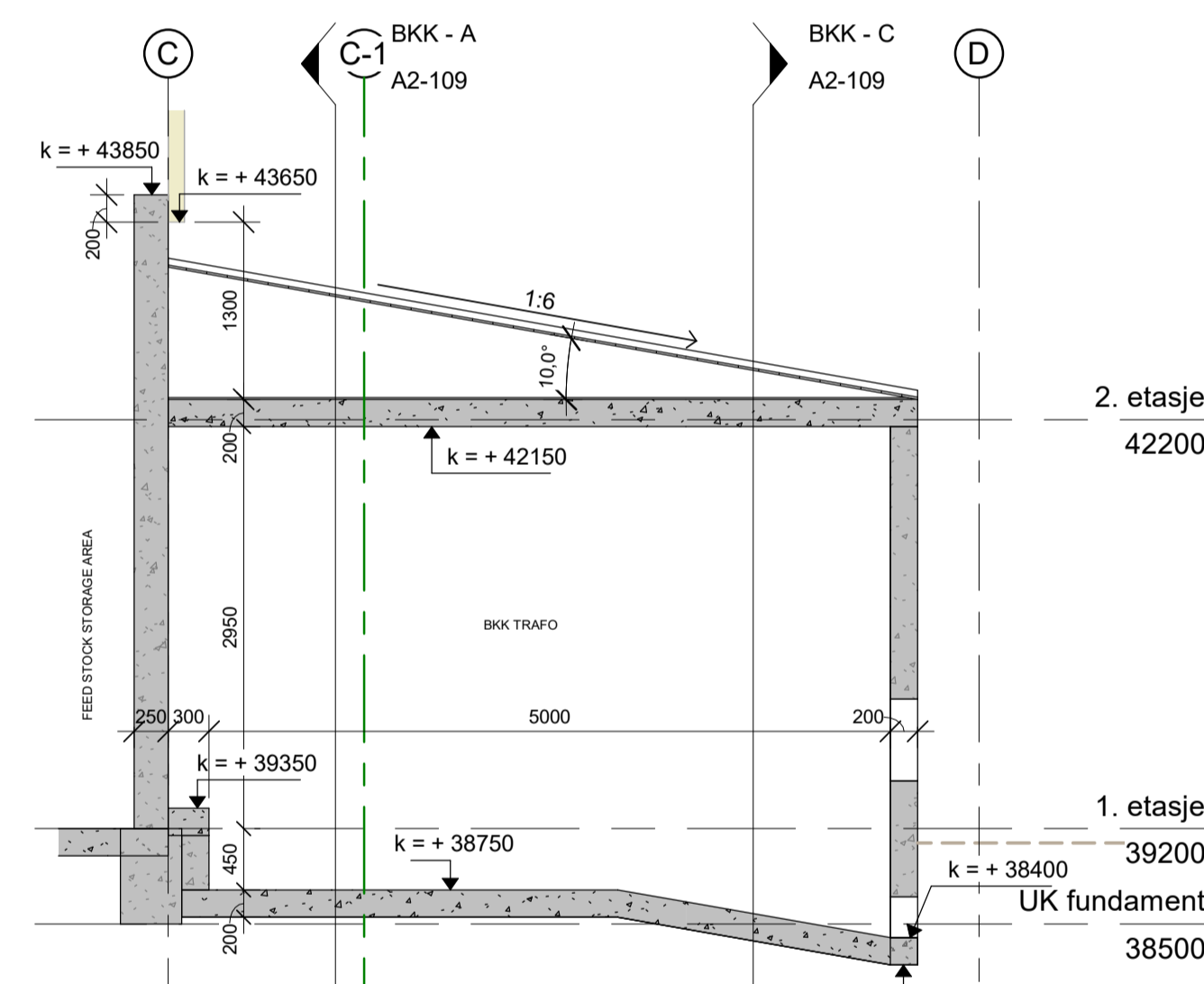

4 BKK - B
1:50

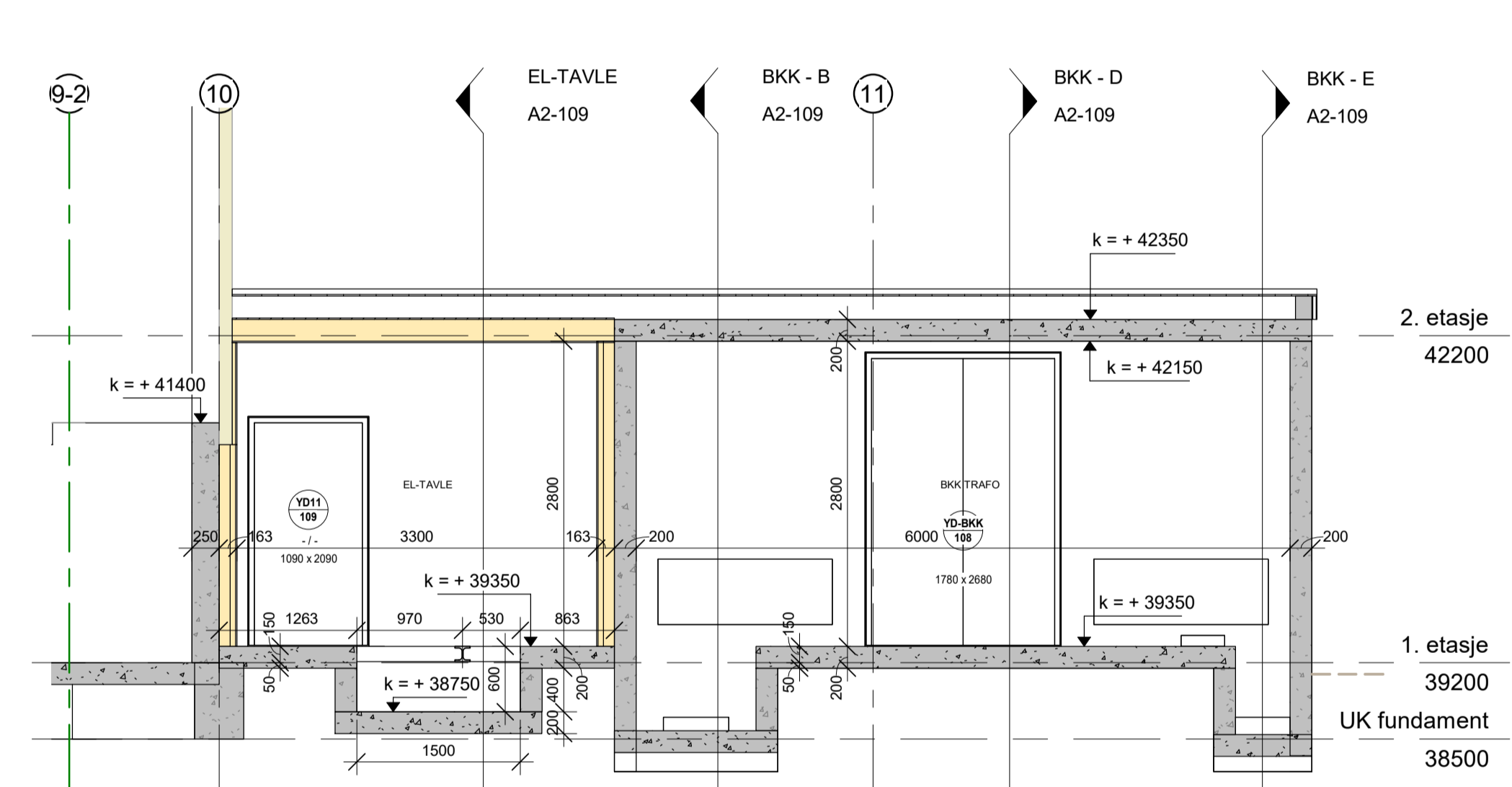

5 BKK - C
1:50

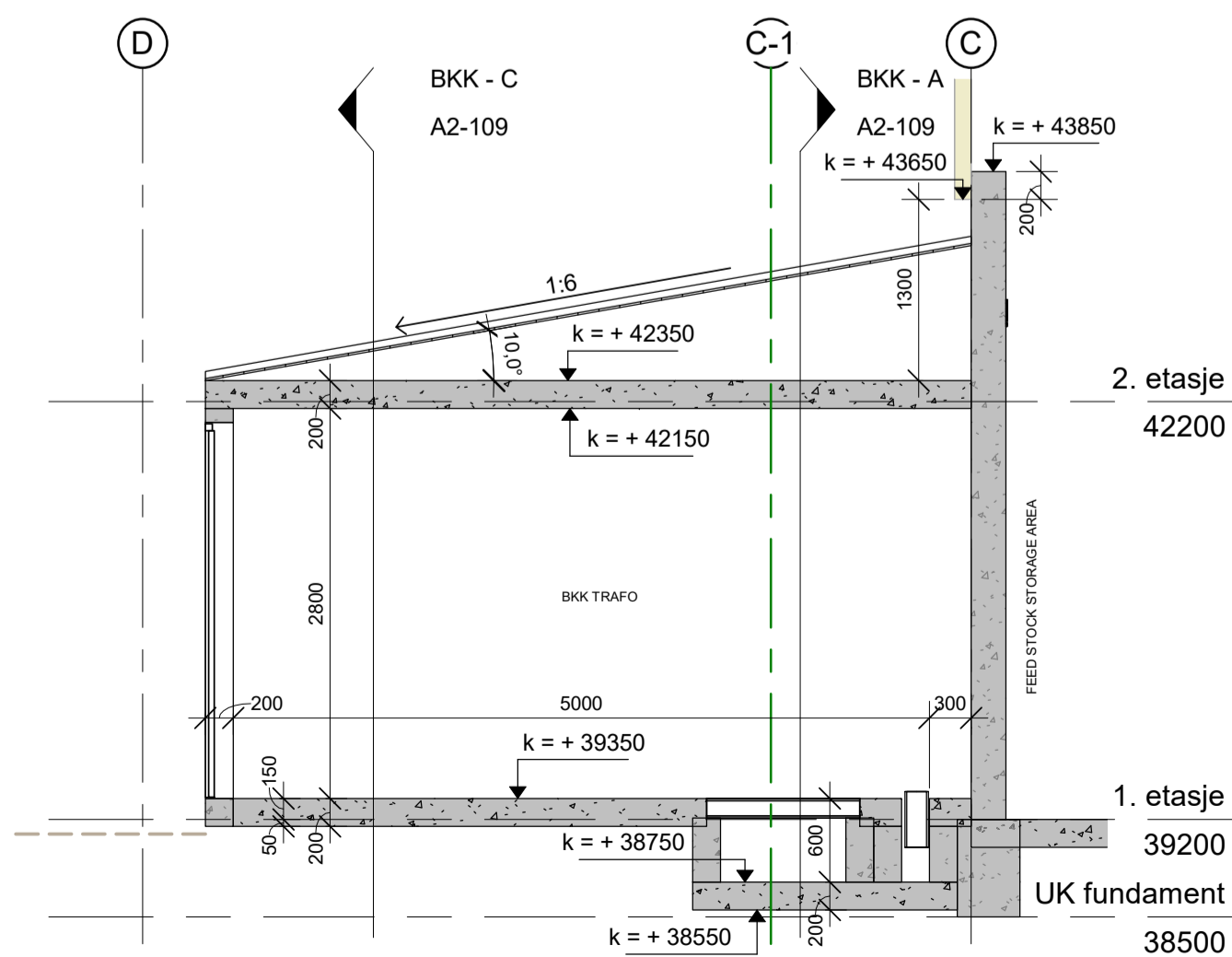

6 BKK - D
1:50

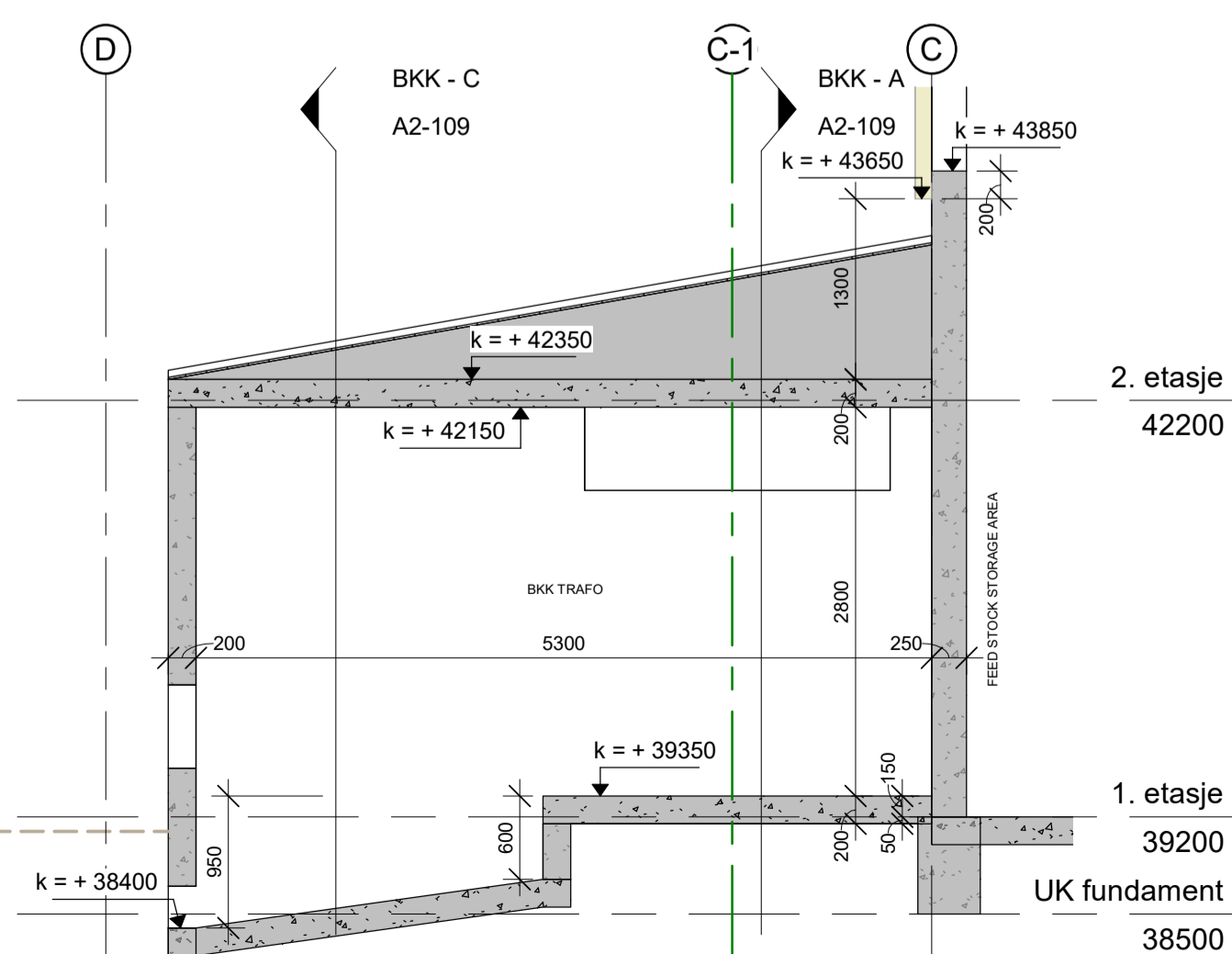

7 BKK - E
1:50

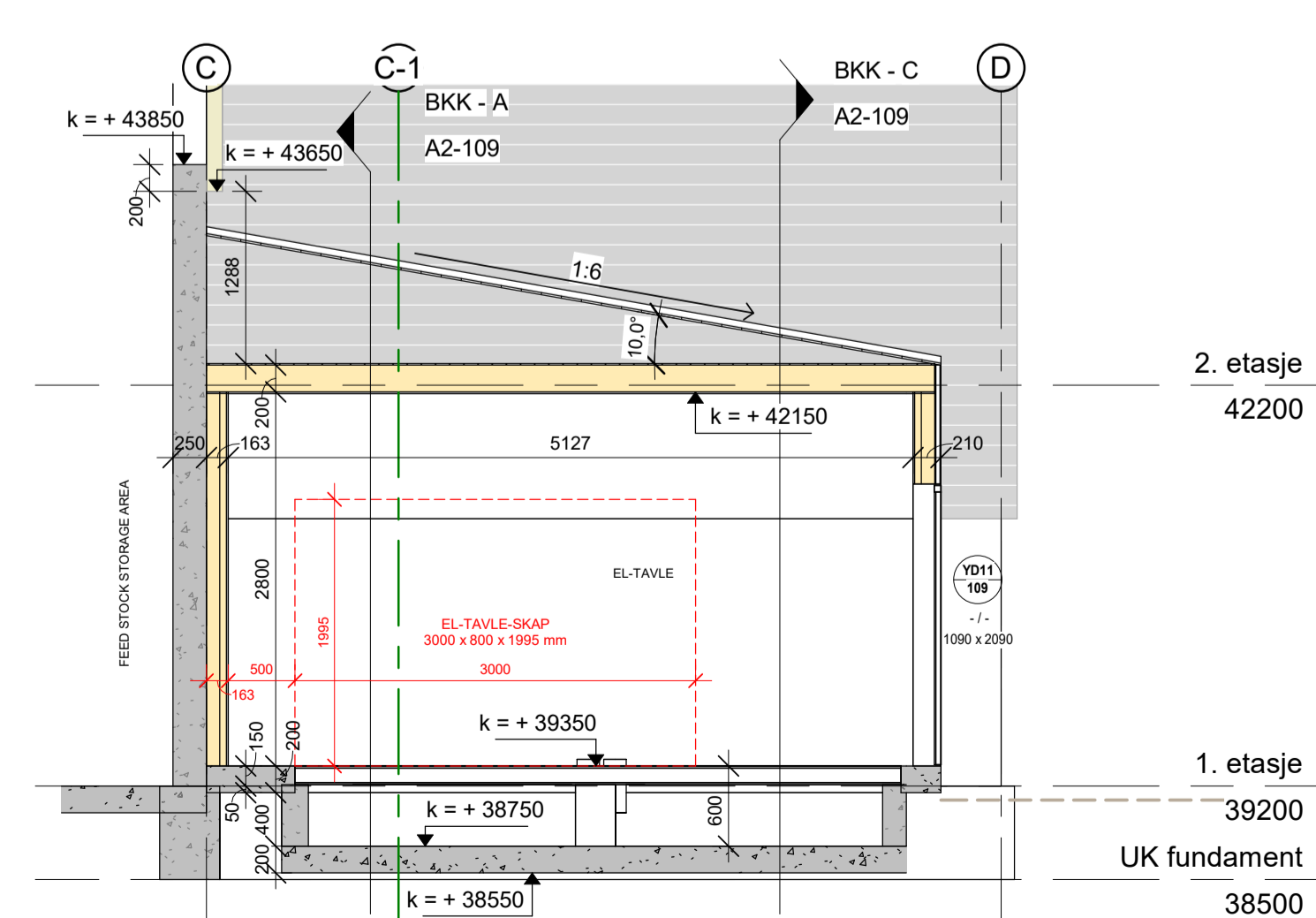

8 EL-TAVLE
1:50

C	13.04.2025	EL-Tavlerom revidert til skisse fra NH Elektro.	MH	PJC
B	18.12.2025	Akse D flyttet om 250 mm mot nord-vest.	MH	PJC
A	09.12.2025	Generell oppdatering BKK-Trafobygg og EL-Tavlerom. EL-ladepunkt supplert.	MH	PJC
REV	LEDD	BRISIKKVERS	TRON	KONTR
23011-Vaskeanlegg FM		ARKITEKTKONTORET BØRTVEIT & CARLSEN AS		
PROSJEKTANSV	MH	HAGELLIA 6 5914 ISDALSTØ TELEFON 400 41 614 post@arkitec.no		
TEKNET AV	PJC	TILTALENSAVNER NGIR - NN- og Gulen Interkomm. renovasjonsselsk. IKS		
ARKITETTSPELLE	A1	KOMMUNE Alver 4631 GSR.ØSN. 177/36		
MALESTOKK	1:50	PROSJEKTNAMN Vaskeanlegg, NGIR		
DATE	02.12.2025	BYGG		
FORELØPIG		TEKNISSKISSE		
TEKNISSKISSE		REVISJON		
A2-109	Trafobygg og EL-Tavle	C		

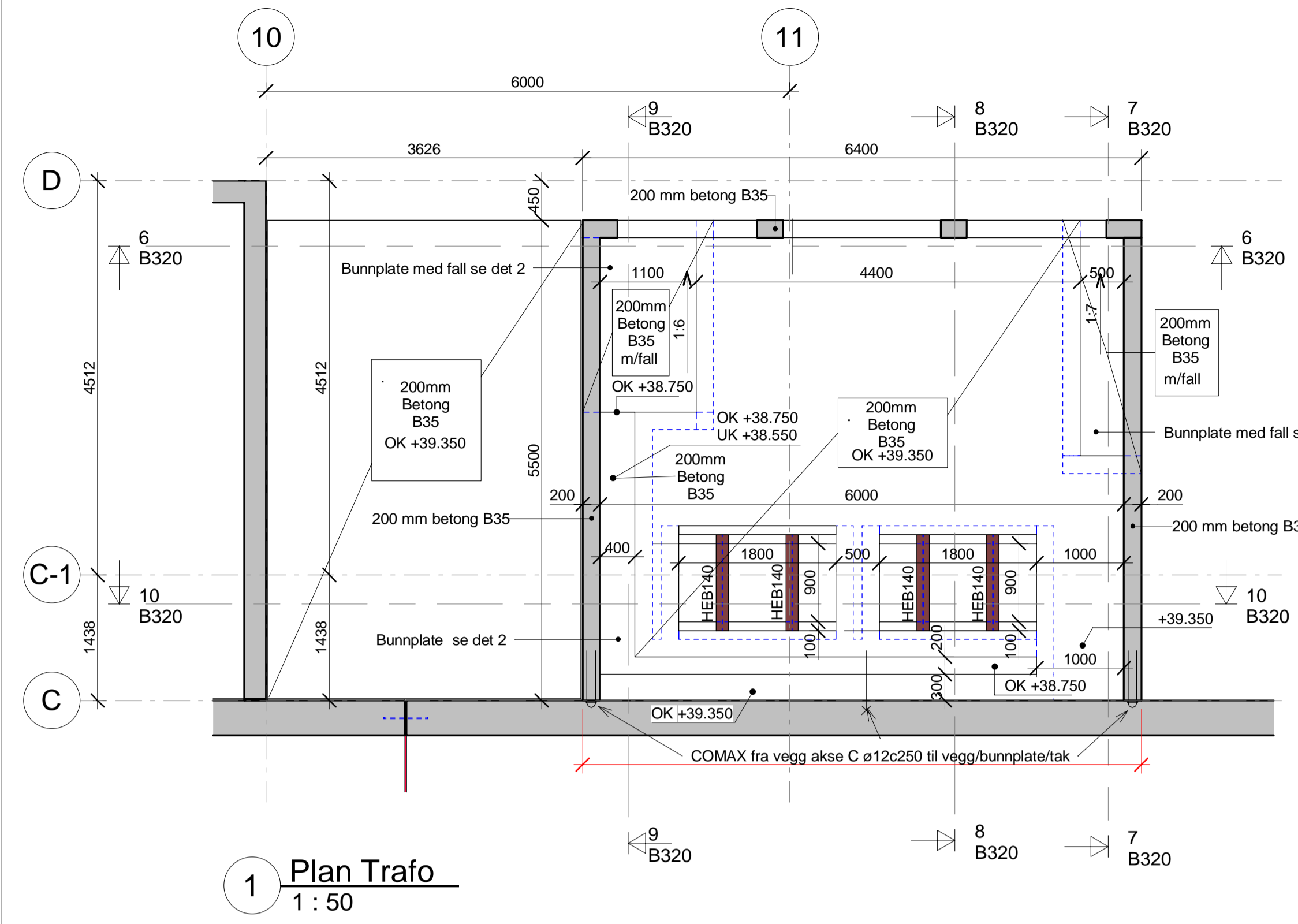

1 Plan Trafo
1:50

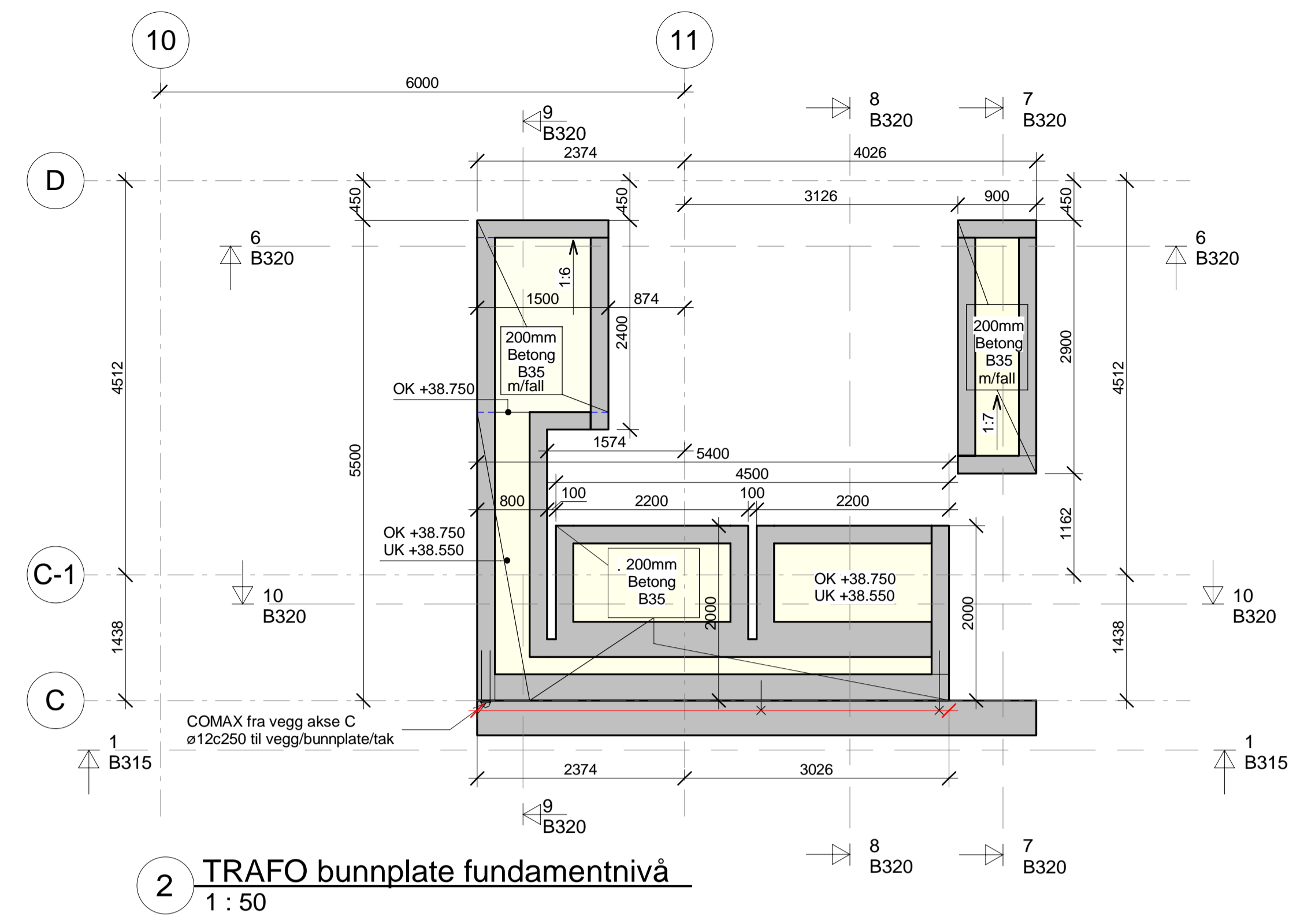

2 TRAF0 bunnplate fundamentnivå
1:50

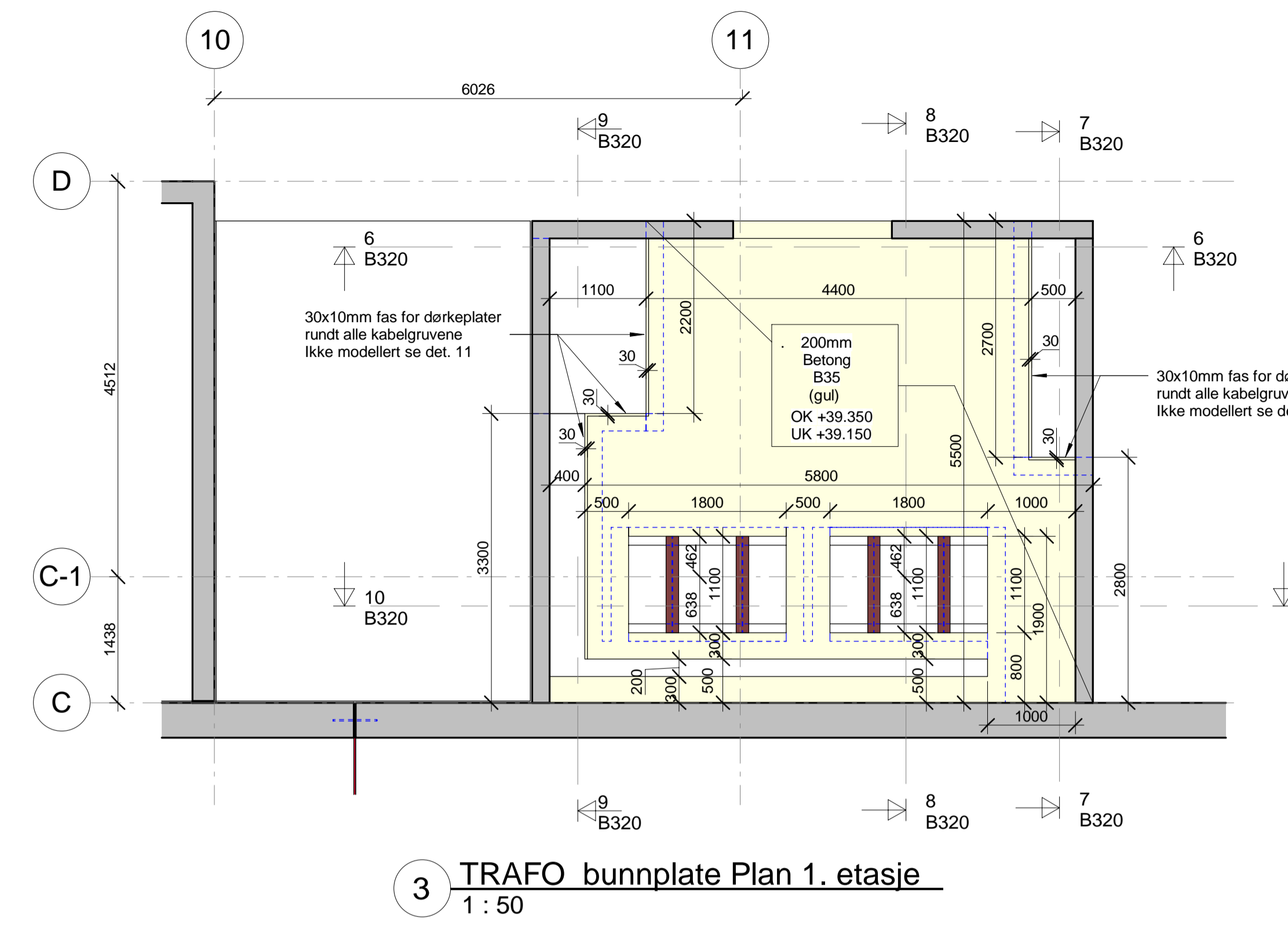

3 TRAF0 bunnplate Plan 1. etasje
1:50

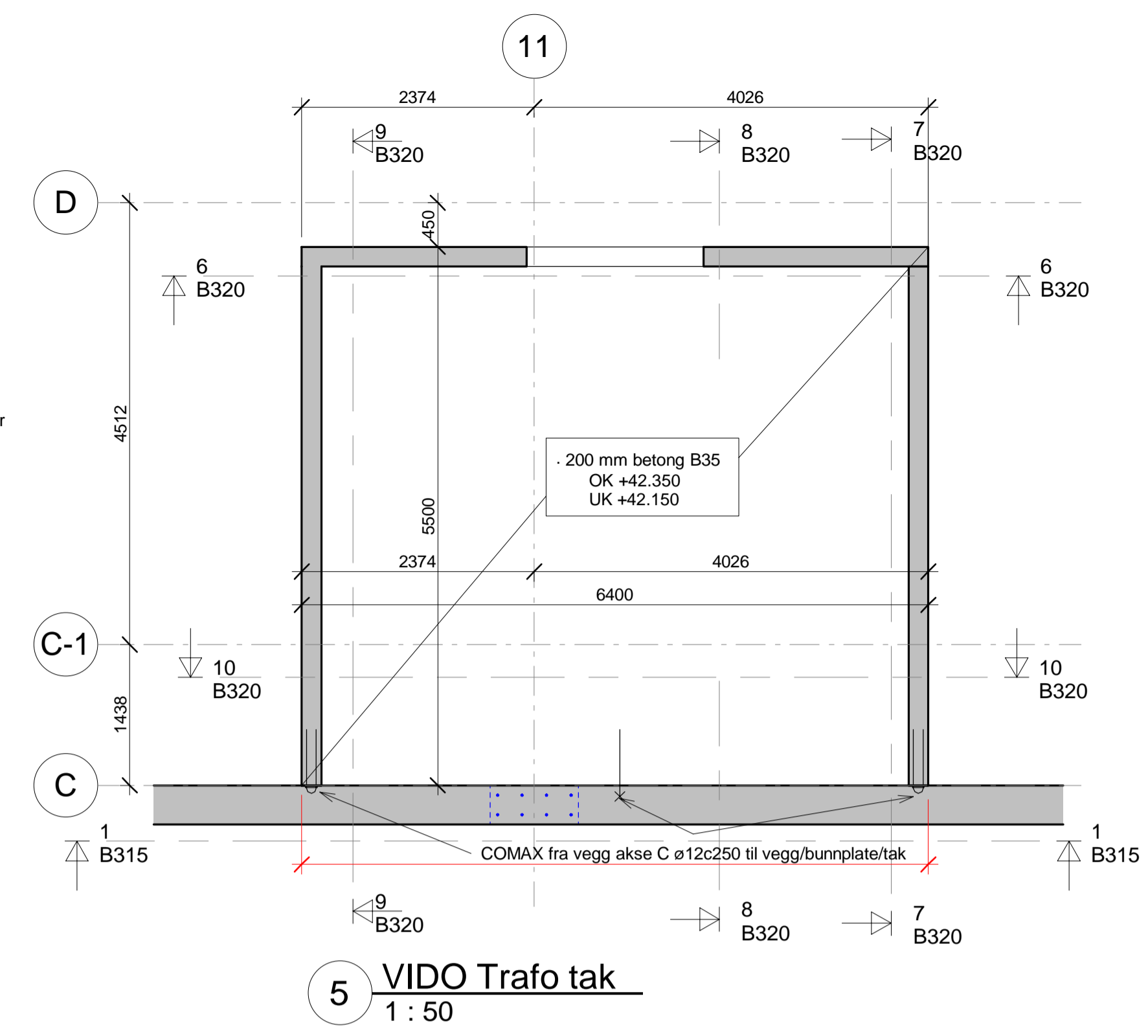

5 VIDO Traf0 tak
1:50

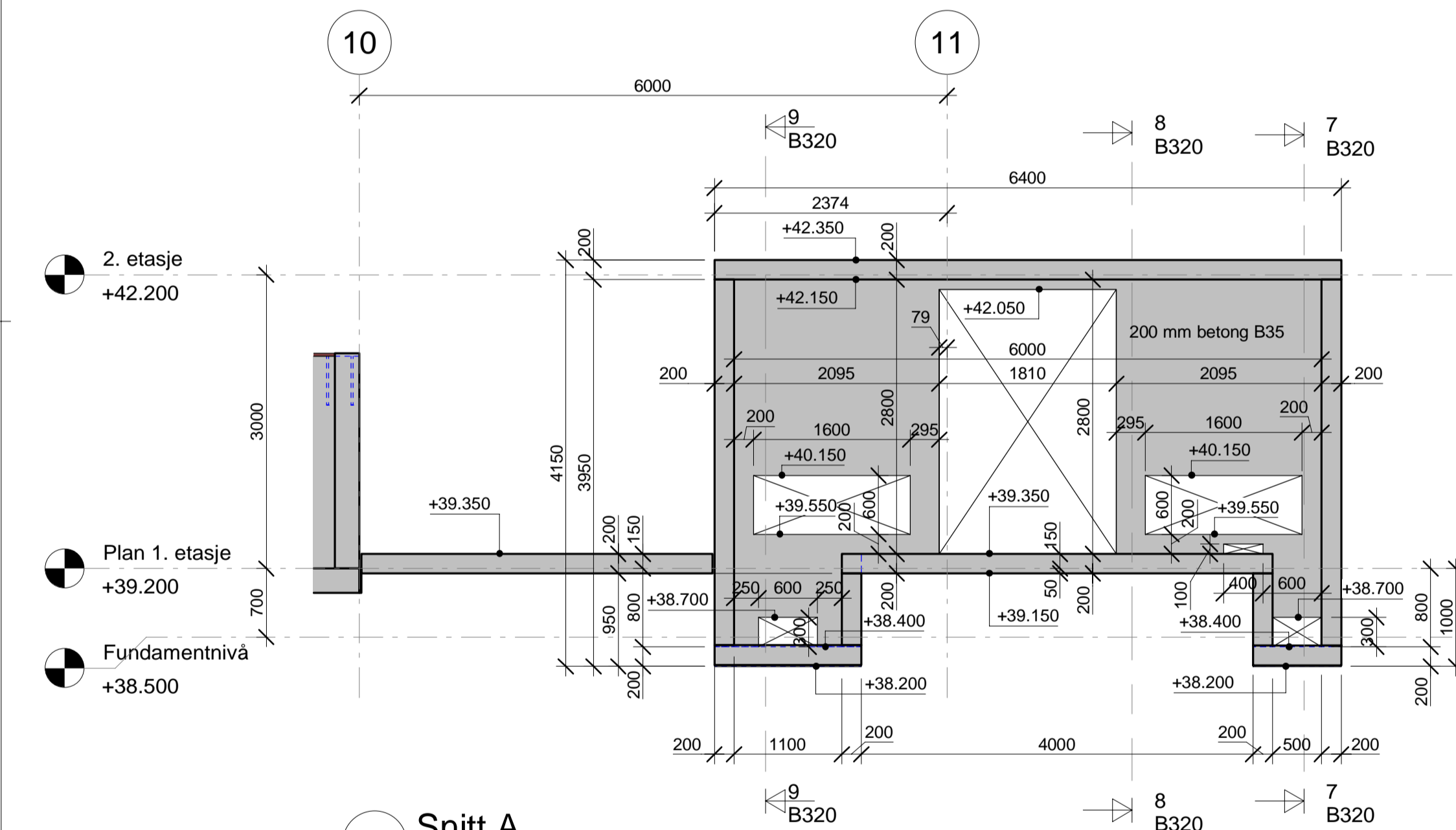

6 Snitt A
1:50

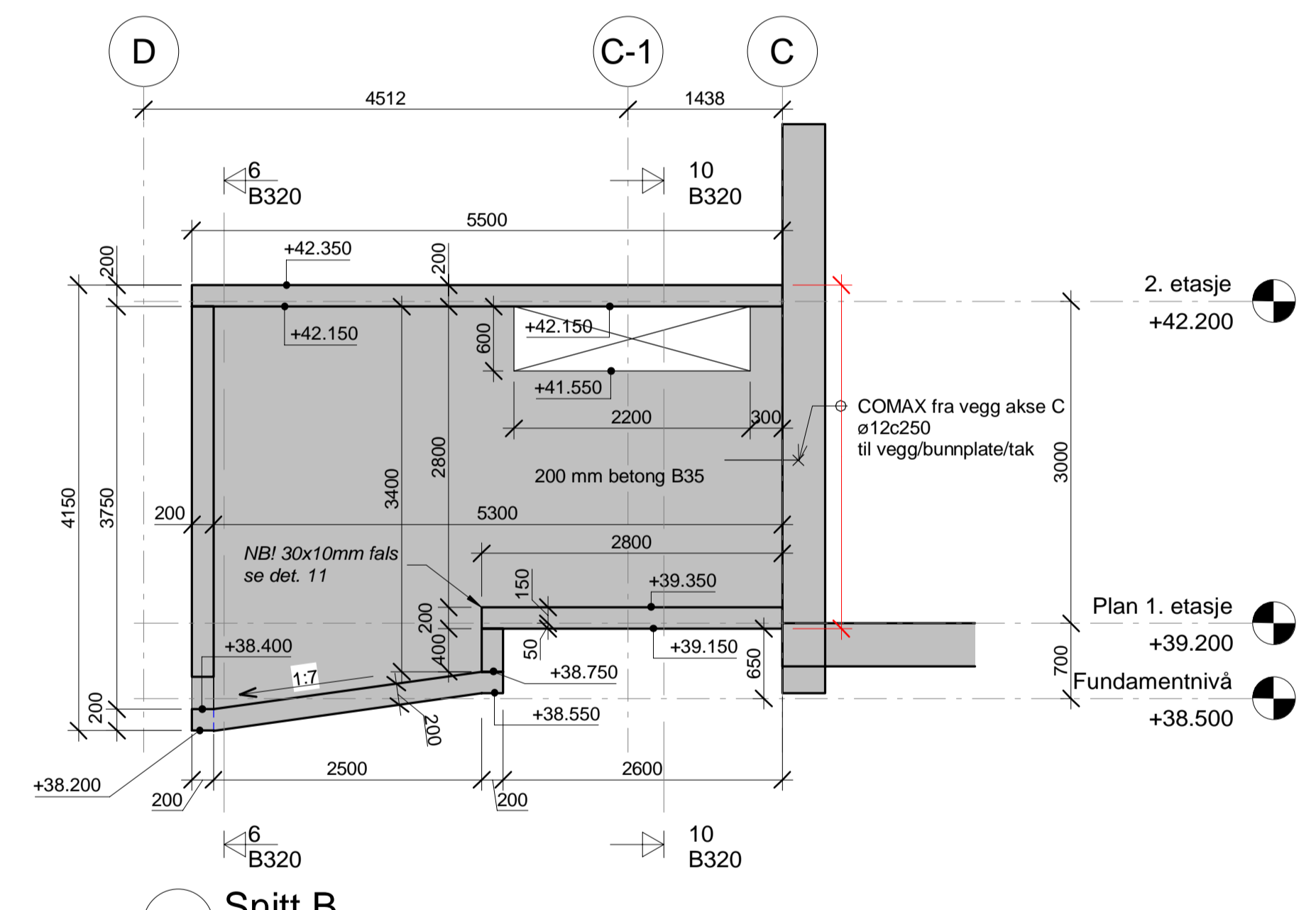

7 Snitt B
1:50

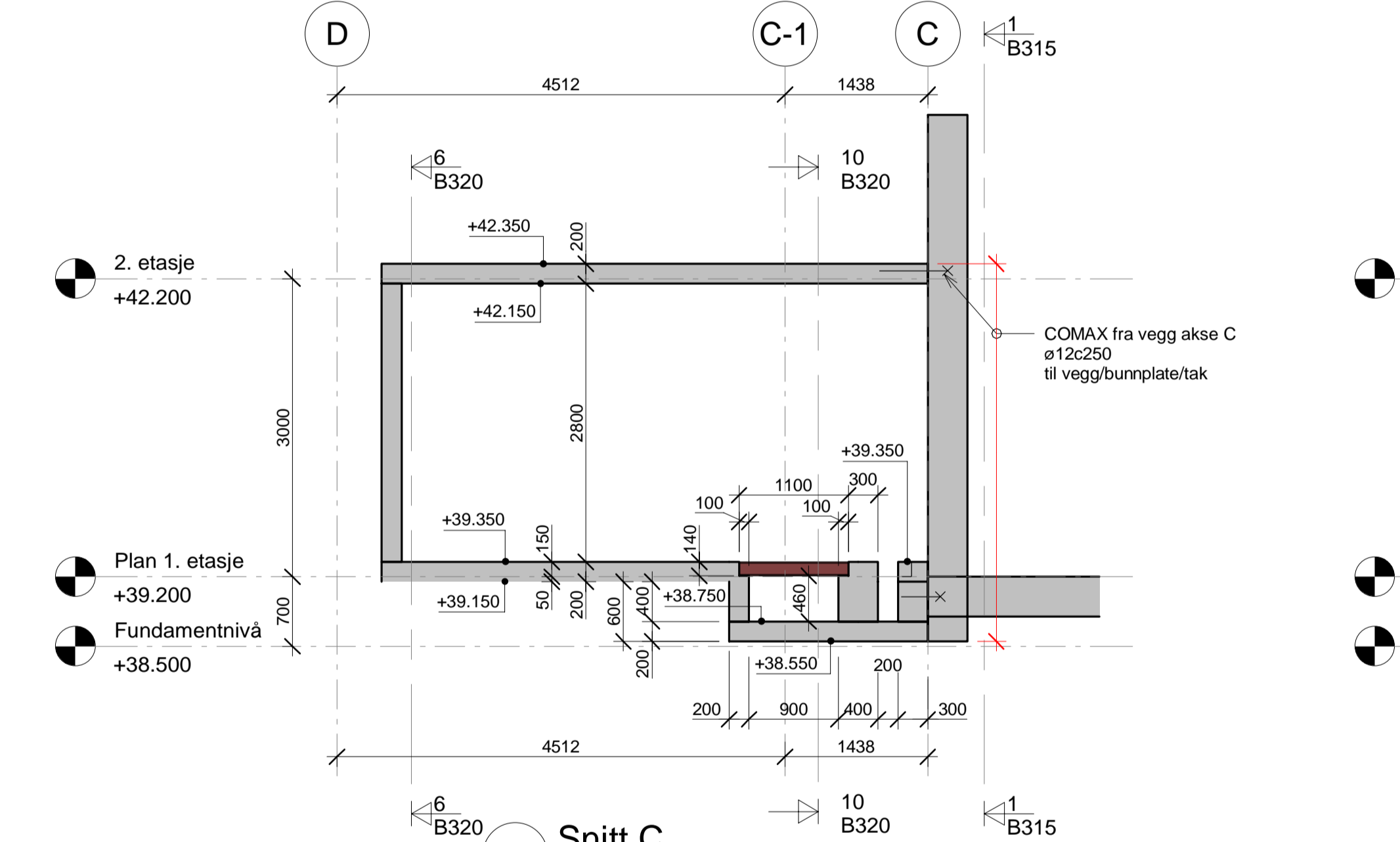

8 Snitt C
1:50

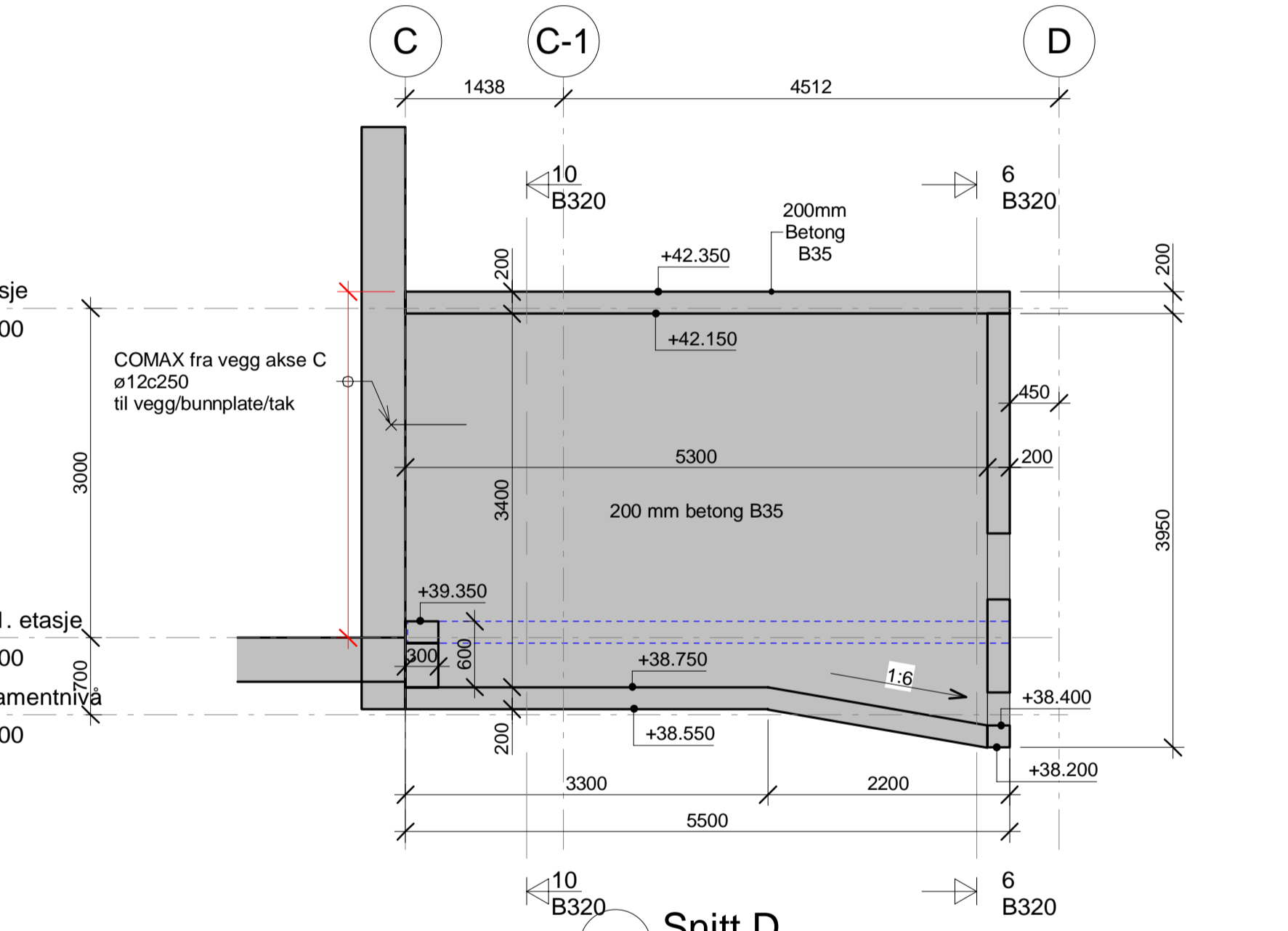

9 Snitt D
1:50

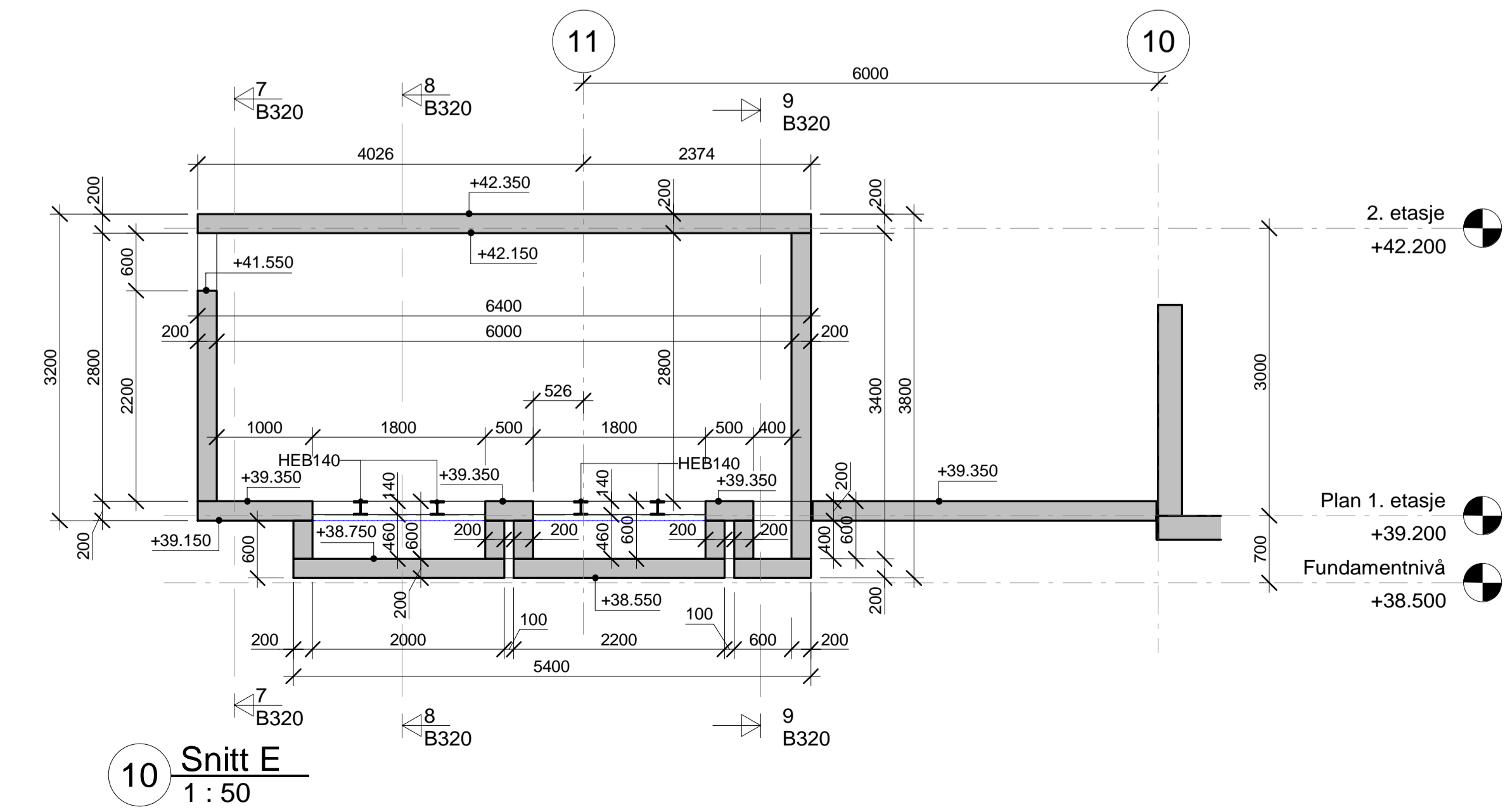

10 Snitt E
1:50

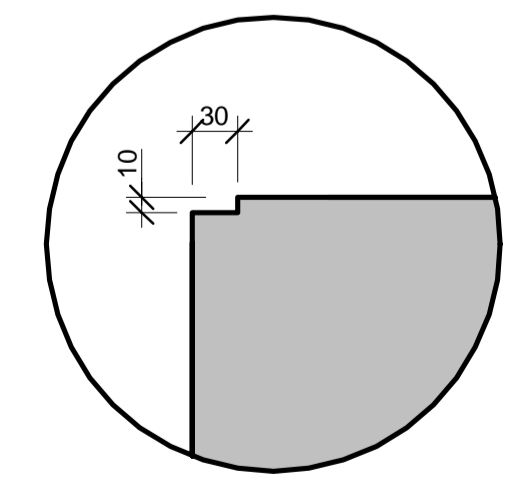

11 DETALJ 11
1:5

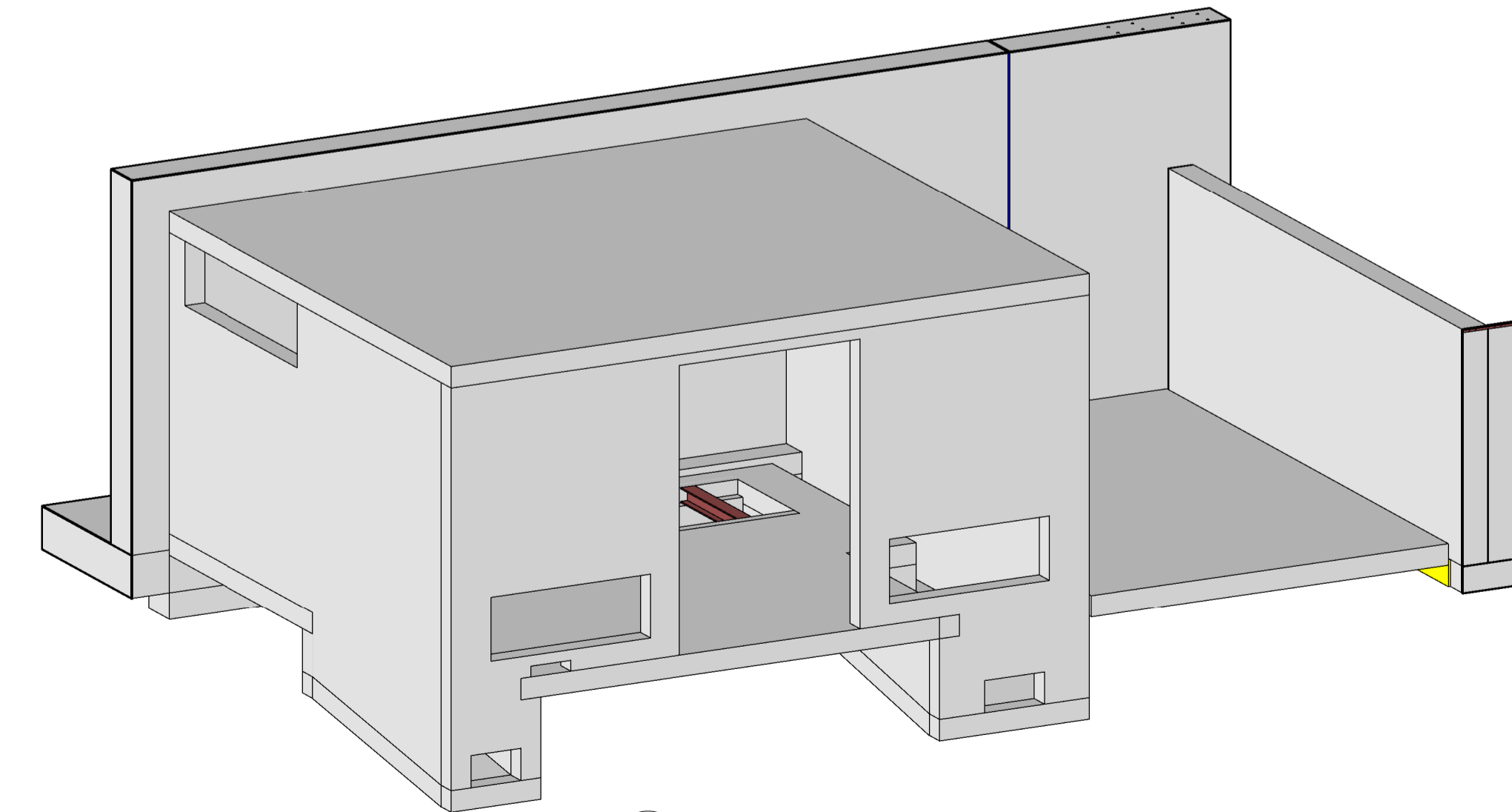

11 3D - Trafo

ANMERKNINGER BETONG IKKE VANNTETT
 - Betongkvalitet betong B35
 - Bestandighetsklasse M45
 - Eksponeringsklasse XC3
 - Kontrollklasse NORMAL
 - Alle skarpe synlige betongkanter avfases

TEGNINGSHENVISNINGER:
 B001 - Tegningsliste
 B002 - Generelle armeringer
 B320 TRAF0
 B525 ARMERING TRAF0

A ARBEIDSTEGNING		10.04.2026	MBO	CAJ
Revisjon	Revisjonsnotat	Dato	Tegnet	Korrigert og godkjent
OPPDRAGSGIVER HTB NGIR Vaskehall TITTEL TRAF0				
konstruksjonsteknikk www.konstruksjonsteknikk.no Kanalveien 52C 5068 Bergen E-mail: post@konst.no		DATO 10.04.2026 PROSJEKTNR. 25025	TEGNER MBO PROSJEKTLEDER CAJ DRUKK CAJ	TEGNING B320 REV. A

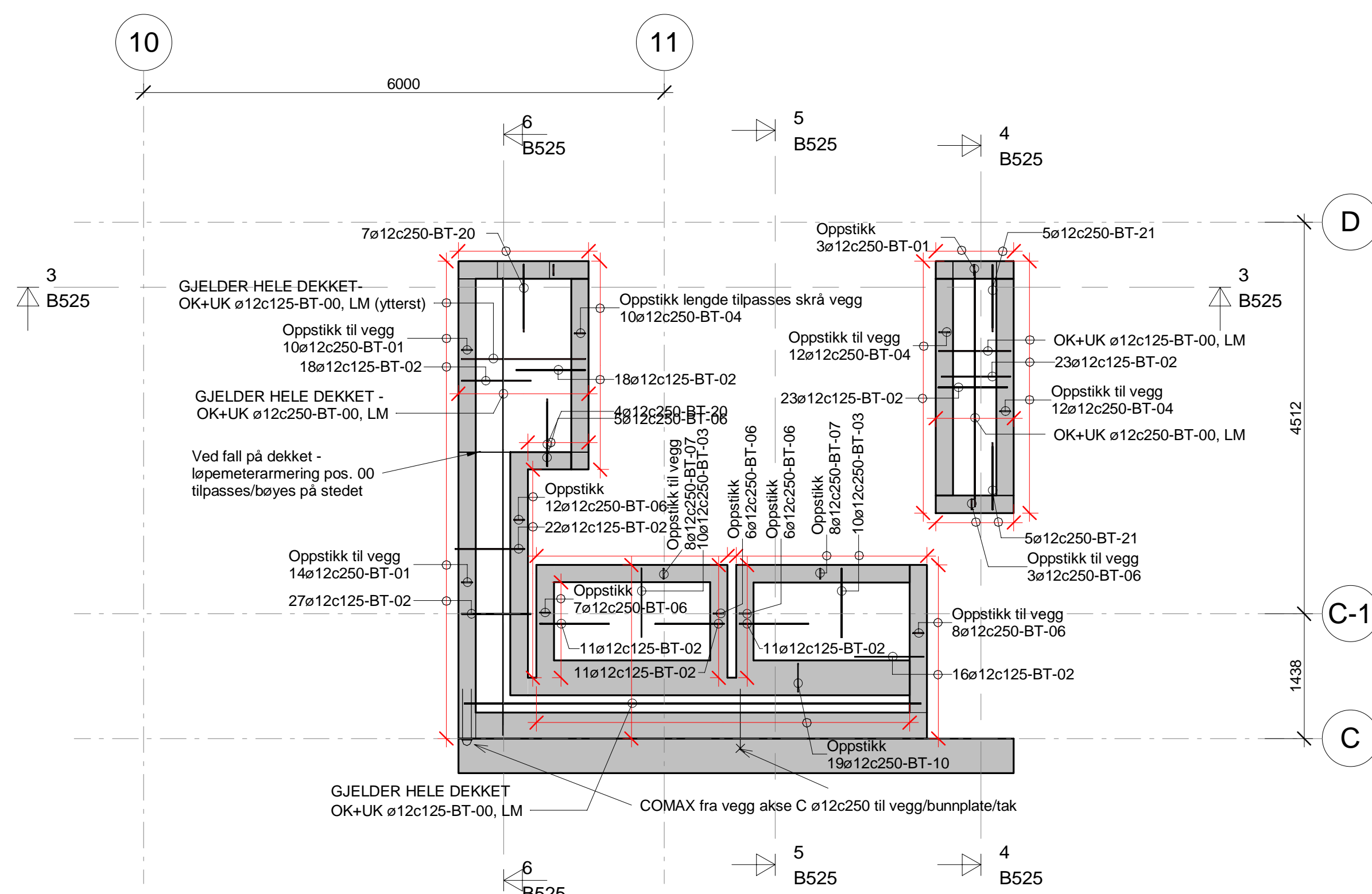

9 ARM TRAFØ bunnplate fundamentnivå
1 : 50

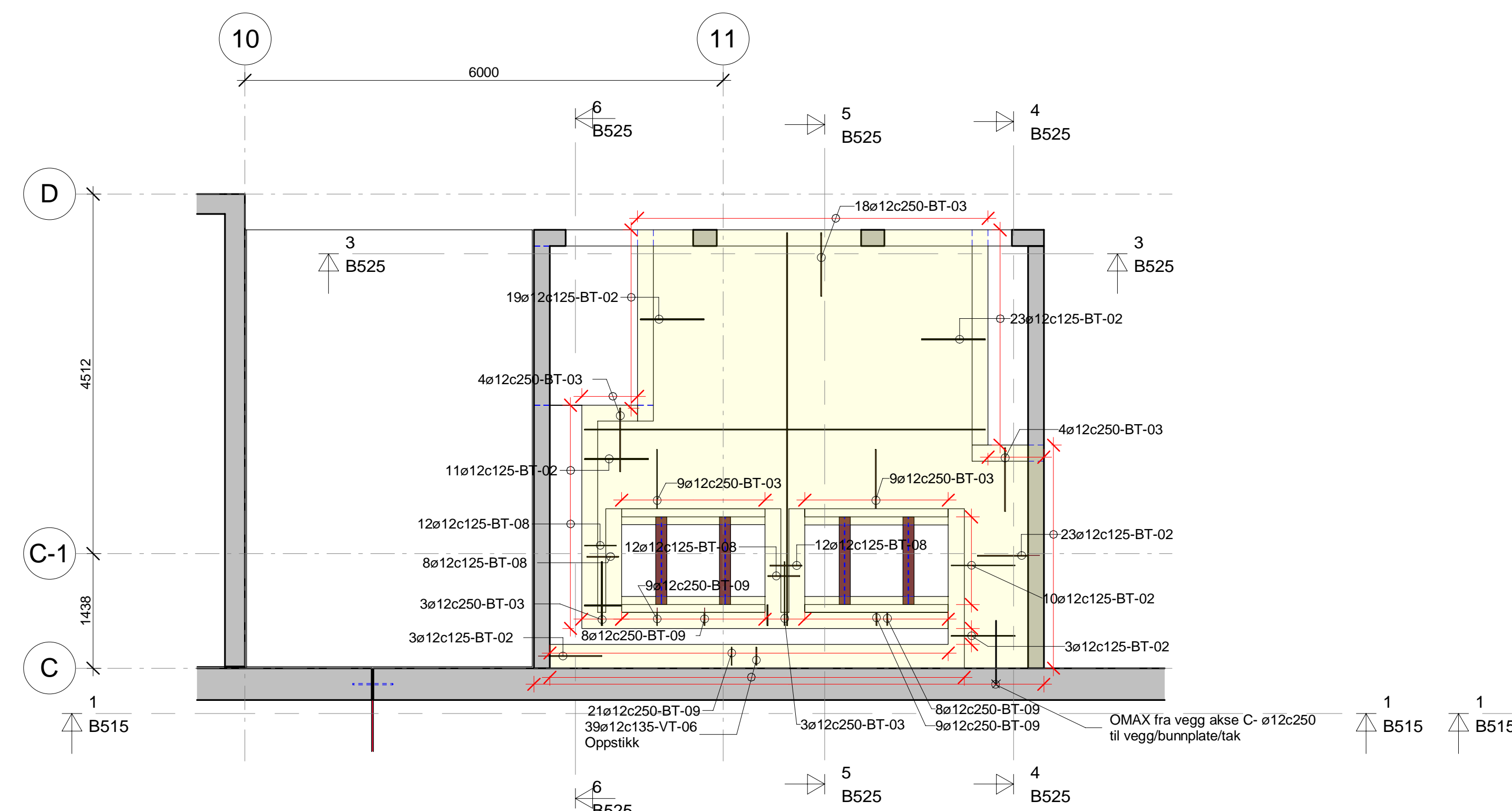

1 ARM TRAFØ bunnplate Plan 1. etasje
1 : 50

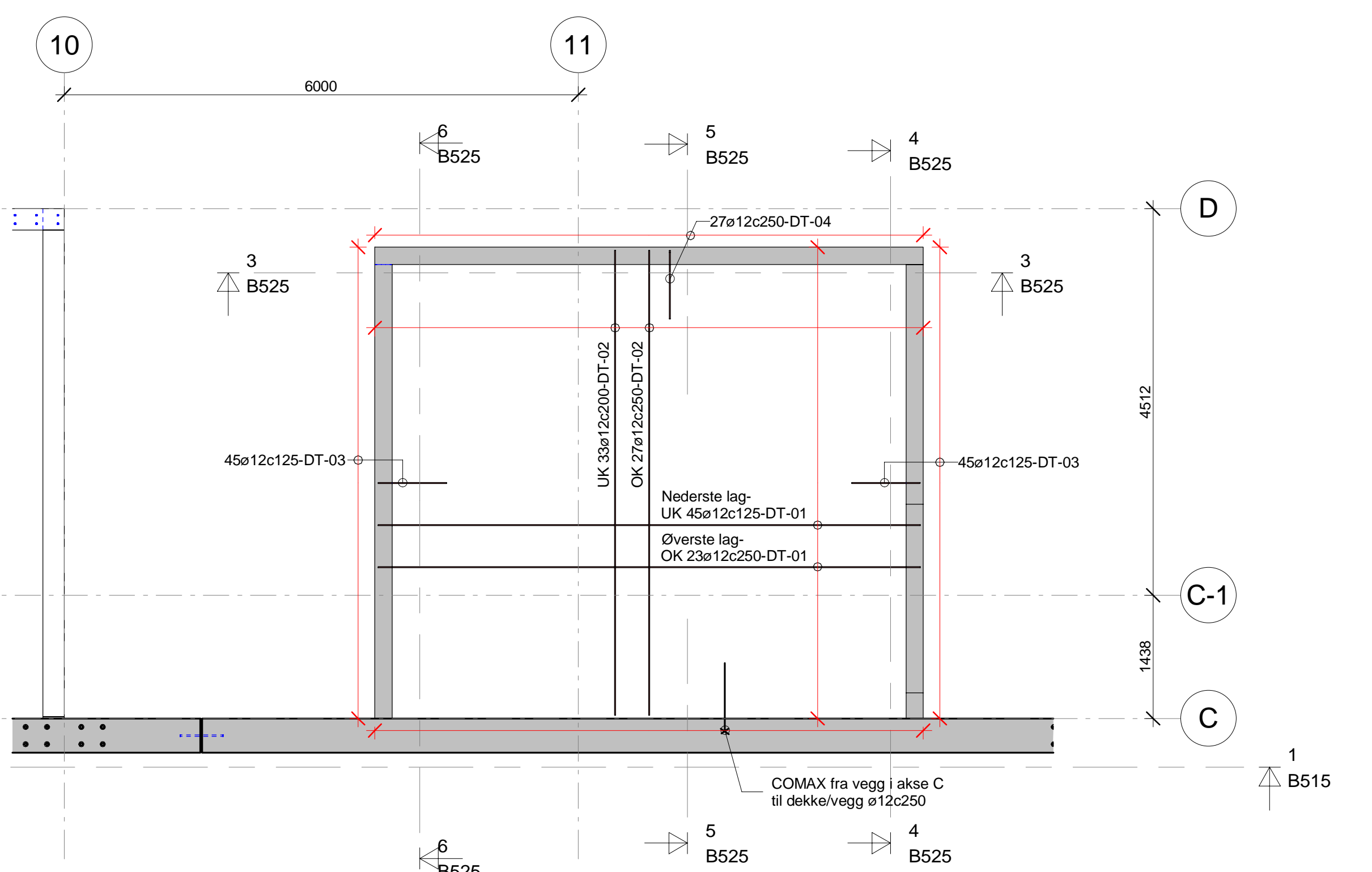

11 ARM Tak
1 : 50

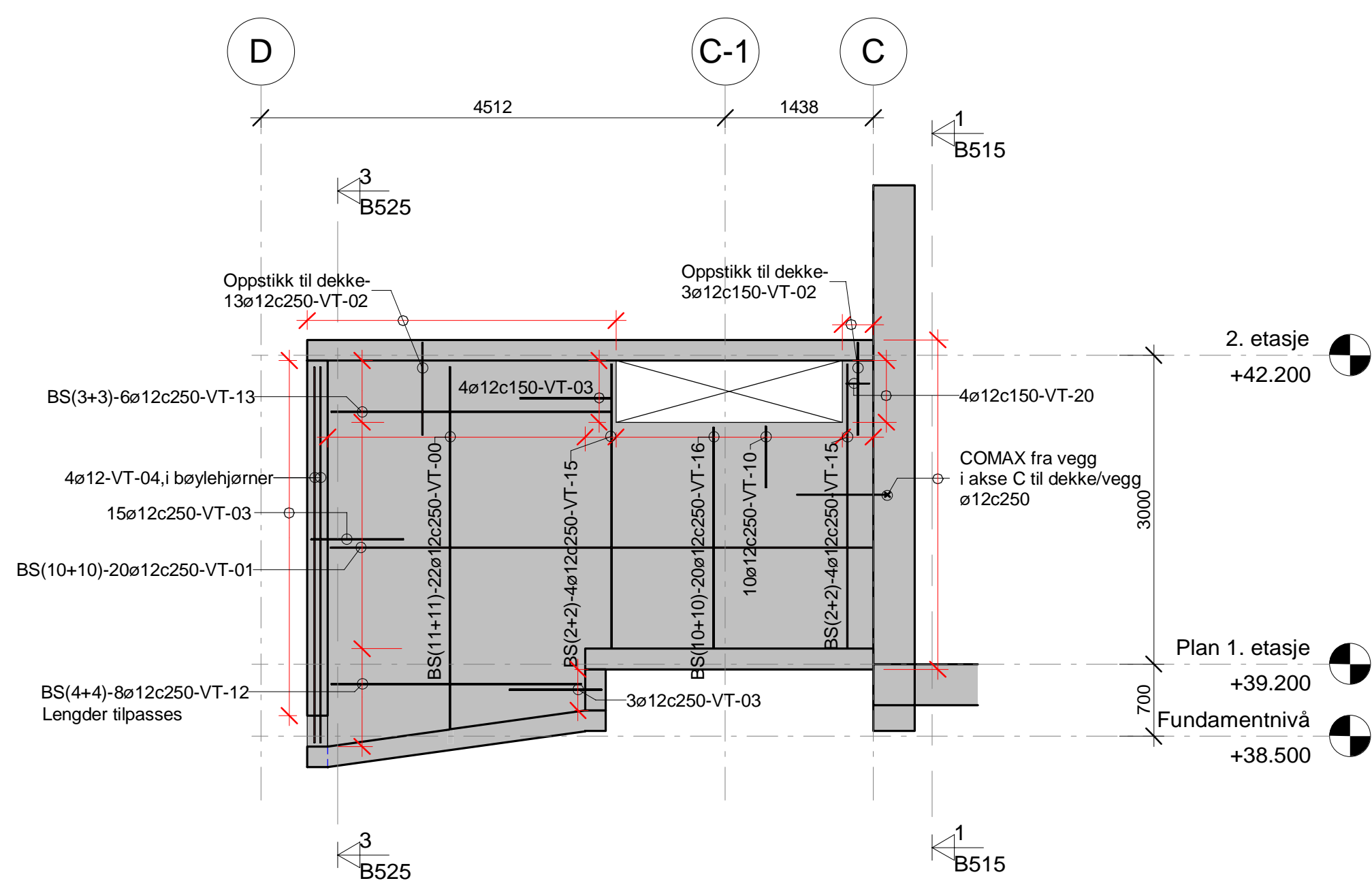

4 ARMERING - Snitt B
1 : 50

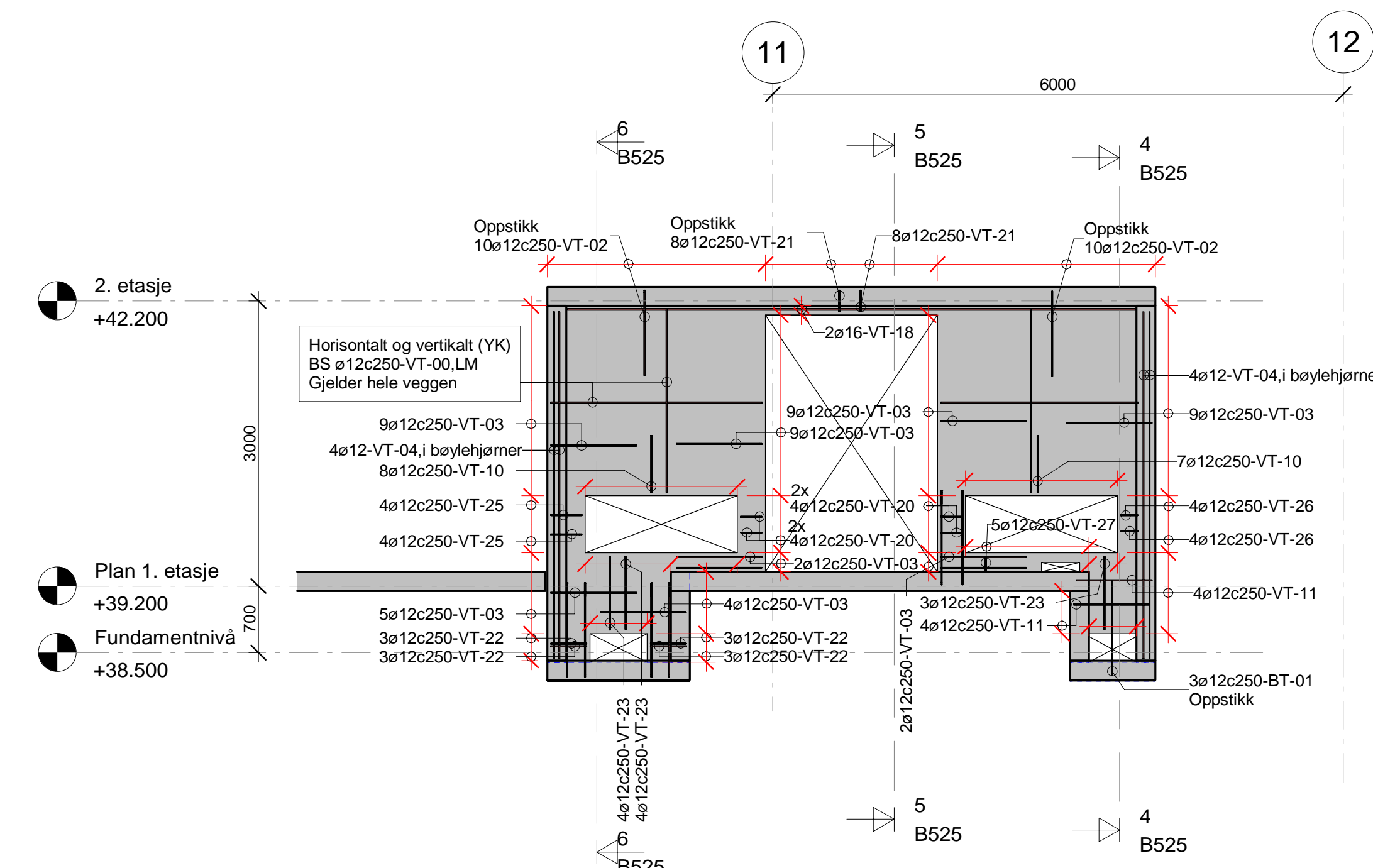

3 ARMERING -Snitt A
1 : 50

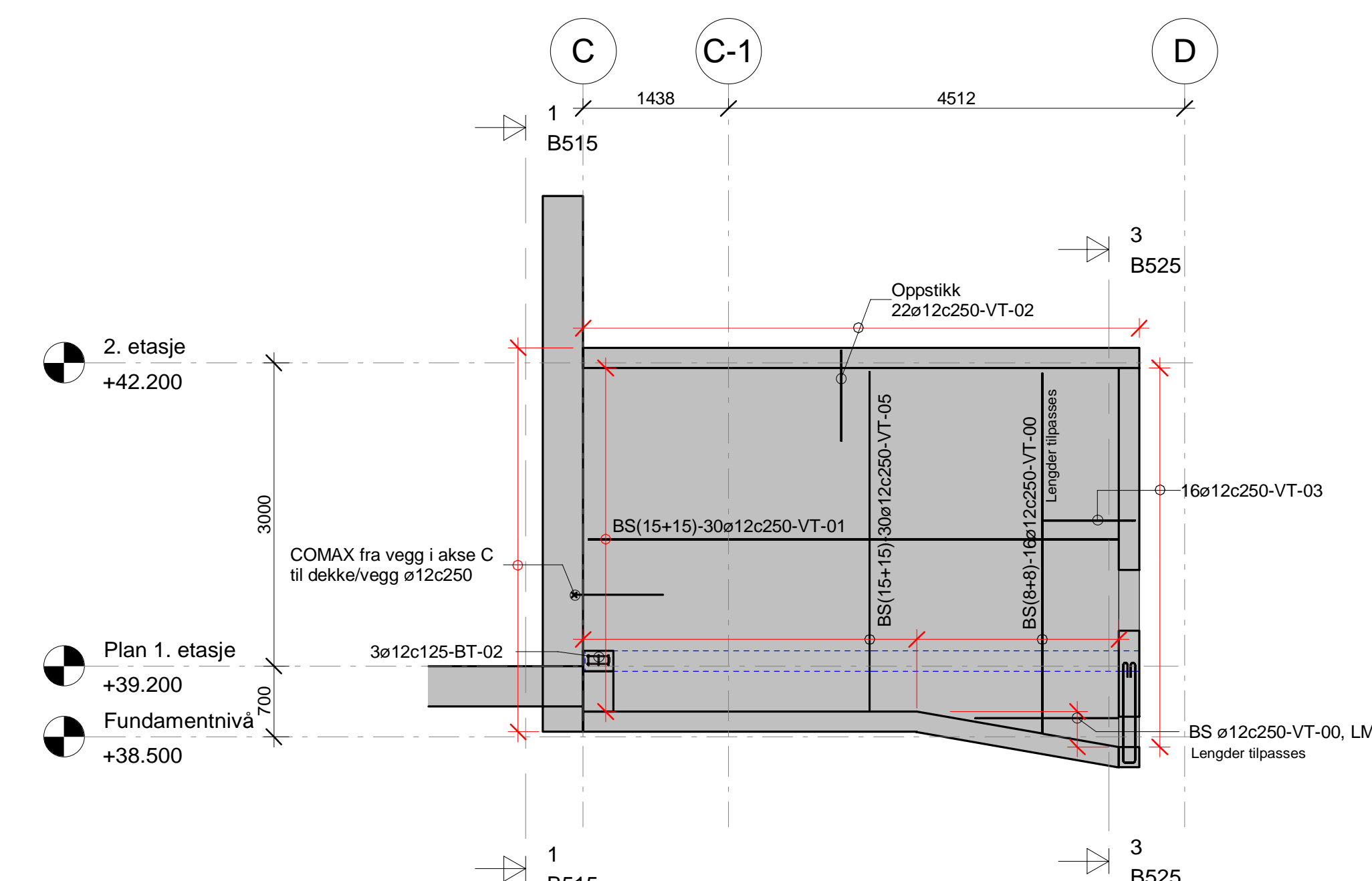

6 ARMERING - Snitt D
1 : 50

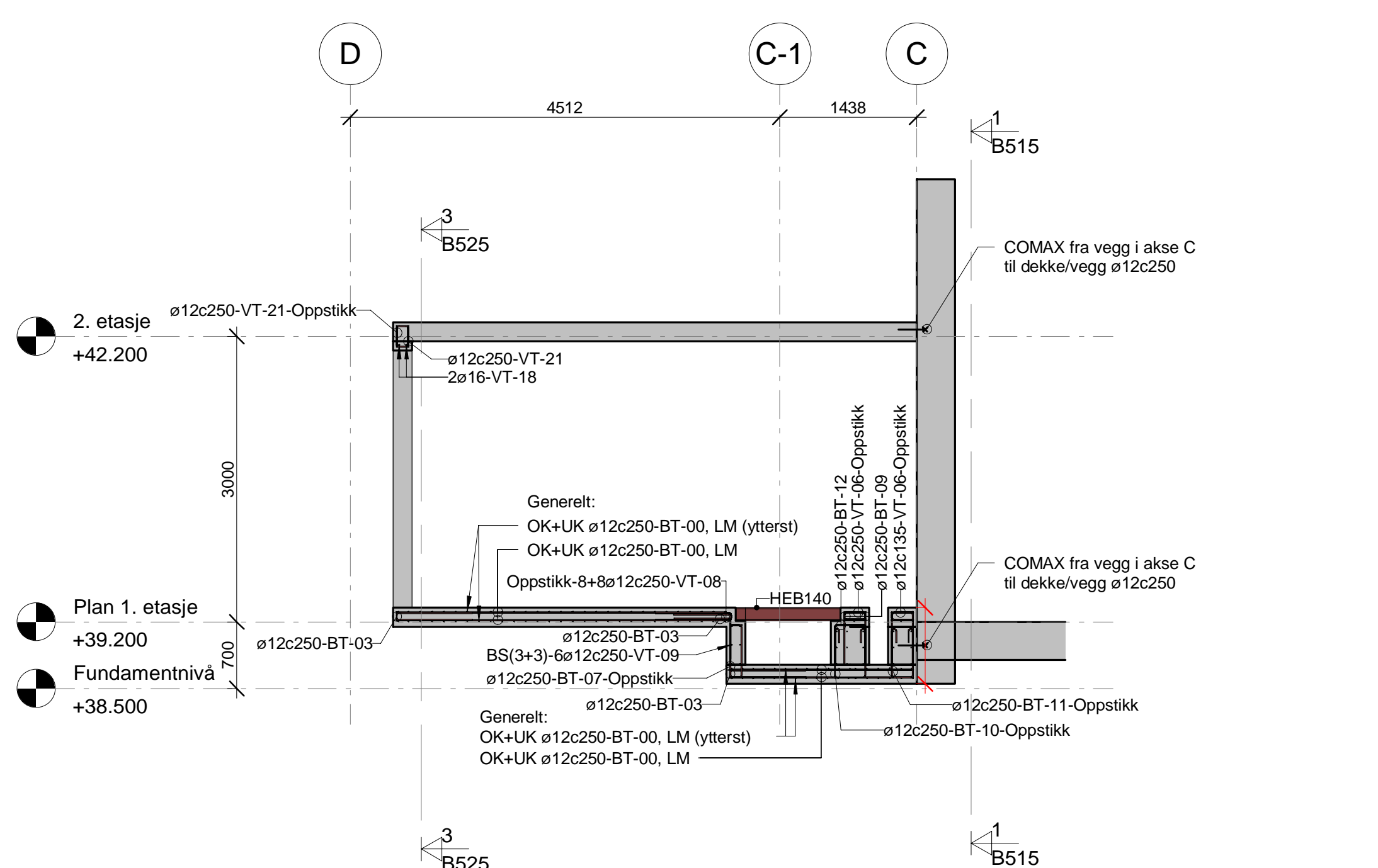

5 ARMERING - Snitt C
1 : 50

ANMERKNINGER BETONG IKKE VANNTETT
 - Betongvalvet betong B15
 - Bestandsklasse M45
 - Eksponeringsklasse XC3
 - Kontrollklasse NORMAL
 - Armeringsvalvet B500NC
 - Overdekning:
 Bunnplate UK 50+10mm
 Bunnplate eters 35+10mm
 Betongvegger 35+10mm
 Betongdekker (tak) 35+10mm

Generelle anmerkninger
 - Skjeter veksles
 - Vertikalt skjætarmering sikres med kopp eller krok
 - Alle skarpe synlige betongkanter avfases

TEGNINGSBENIVNINGER

B001 - Tegningsliste
 B002 - Generelle anmerkninger
 B320 TRAFØ
 B525 ARMERING TRAFØ

Bøyelister - BT-1, BT-2, VT-1, VT-2, VT-3, DT-1

A ARBEIDSTEGNING		10.04.2026	MBD	CAJ
Revisjon	Beskrivelse	Dato	Tegnet	Korrigert og godkjent
1	HTB NGIR Vaskehall			
Armering - TRAFØ				
Konstruksjonsteknikk www.konstruksjonsteknikk.no Kvalitet ISO 9001:2015 Telefon +47 996 03 286 E-mail post@konstruksjonsteknikk.no		10.04.2026 25025	10.04.2026 25025	10.04.2026 25025
		B525		A